

EC Backward Curved Centrifugal Fan with Aileron Impeller

Erp2015
EXCEEDS THE NORM

Motorized Backward Curved Impeller



Φ 225-L

Rotor Material: Carbon steel
Impeller Material: Plastic
Ingress Protection: IP44
Insulation Class: F
Bearing Type: Maintenance free ball bearing

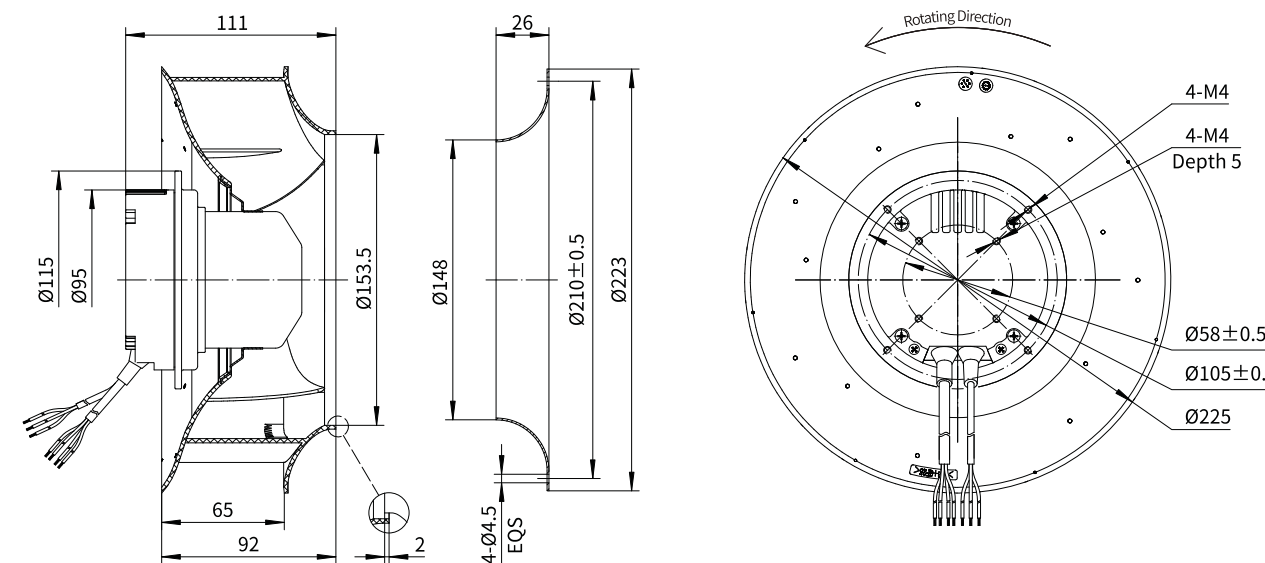

Performance Curves

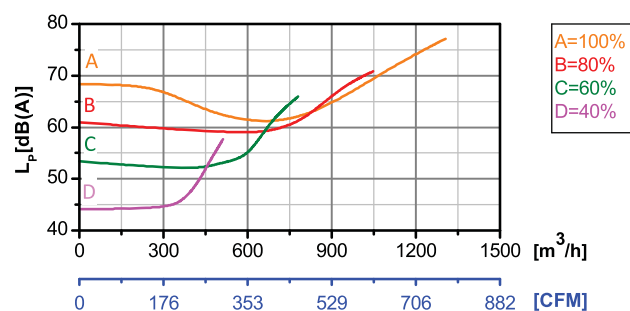
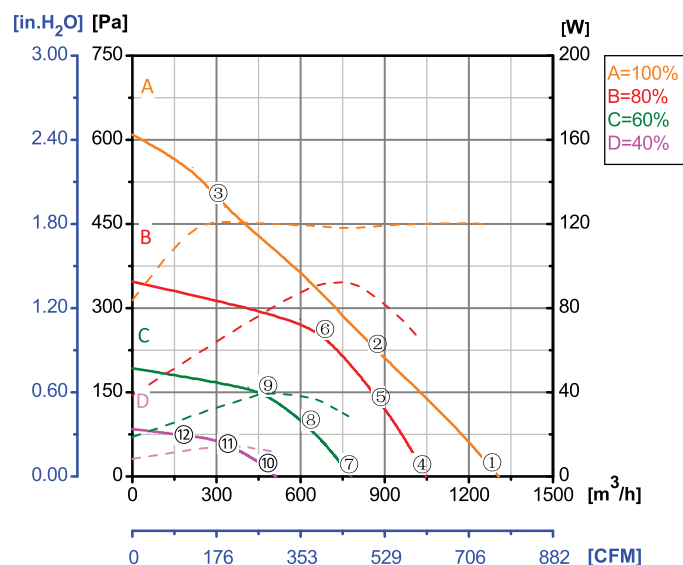

Test Point	Speed	Input Power
	rpm	W
1	2831	119
2	2496	120
3	2722	120
4	2263	61
5	2273	82
6	2278	92
7	1696	28
8	1701	37
9	1702	40
10	1126	11
11	1133	13
12	1129	14

Erp2015 Data:
Efficiency η_{statA}=59.3%
Efficiency grade N_{actual}=79.5, N_{target}=62
Test report No. : L-20210302-005-007

Model No.	Voltage	Frequency	Speed	Input Power	Current	Working Temp.	Approvals
	VAC	Hz	RPM	W	A	Min/Max (°C)	
EC72-B225-003	1~220/230	50/60	2850	120	1.00	-20/+60	CCC,CE